

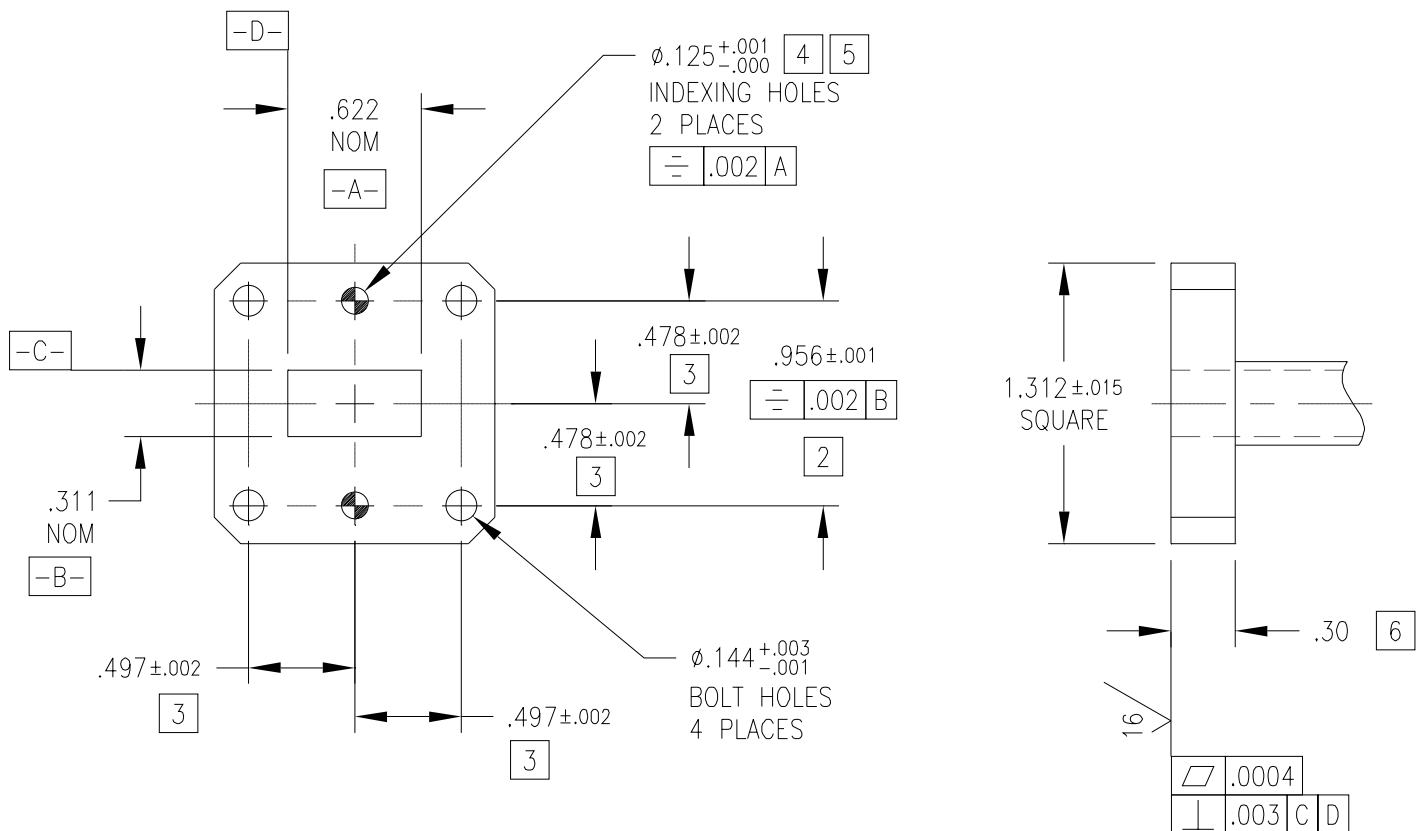

# PRECISION WR62 FLANGE

MPF62 1



1 This flange mates with UG-419/U or UG541A/U flanges.

2 This dimension applies to the 0.125 indexing holes only.

3 This dimension applies to the 0.144 bolt holes only.

4 Indexing holes are drilled after flange to waveguide assembly.

5 Use indexing pins W996-4-1 or W996-4-2 (see data sheet 3A-996).

6 May vary depending on device.