

PRECISION TERMINATION

MPC14 (14mm) Connector

Features

- 14mm Precision Connector
- Broad Band
- Low VSWR

Description

Maury model 2410A precision terminations are 14mm fixed resistive loads supplied with a precision MPC14 connector.

Designed for operation from DC to 8.5 GHz, these devices exhibit extremely low VSWR characteristics and are useful for a broad range of measurement applications, such as for network analyzer calibration, etc.

Chart

Model	VSWR Specification
2410A	$1.005 + .004 f$ (GHz)

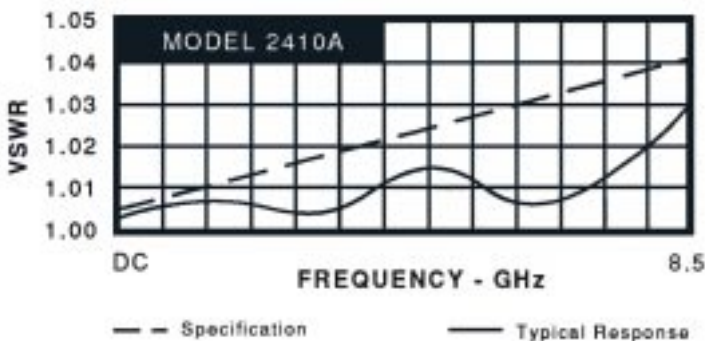

2410A

Specifications

Frequency Range	DC - 8.5 GHz
VSWR.....	See chart
Power Handling.....	3 watt CW, 1 kW peak
Nominal Impedance	
DC Resistance.....	50 ohms nominal
Connectors	MPC14 (14mm) ¹

Dimensions — Inches (cm)

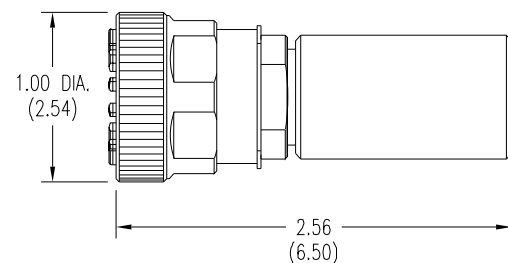

¹ Mates with and is essentially the same as a GR900BT connector.