



FIXED TERMINATIONS

BNC — HIGH PERFORMANCE

Description

The Maury 351A2 and 351B2 are high performance BNC terminations featuring very low VSWR over the DC to 10 GHz frequency range. These terminations are useful for a variety of general purpose laboratory applications; however, because of their very low VSWR, they are especially well suited to critical measurement situations such as calibration and verification of vector and scalar network analyzers (VNA and SNA).

In VNA applications the terminations can be used for a one-port OSL calibration using the fixed load technique. Two terminations are used for the isolation measurement in a two-port calibration and to verify the noise floor of the analyzer.

The 351A2 and 351B2 are lightweight, compact, rugged units and are negligibly affected by temperature and humidity.

Specifications

Frequency Range DC to 10 GHz
 VSWR See chart
 Nominal Impedance 50 ohms
 DC Resistance 50 ± 0.5 ohms
 Maximum Rated CW Power 2 Watts
 Maximum Rated Peak Power 1 kW
 Connectors See chart



Model 351A2

Model 351B2

Chart

Model	Connector	Maximum VSWR
351A2	BNC female	DC — 2 GHz, 1.04
		2 — 4 GHz, 1.10
351B2	BNC male	4 — 10 GHz, 1.20

Dimensions

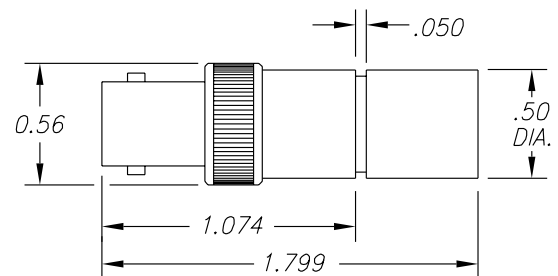

Figure 1. Model 351A2 Termination

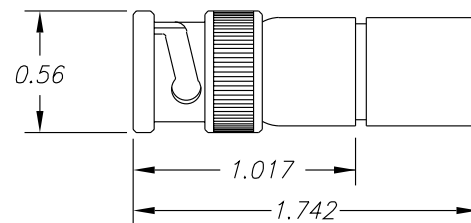

Figure 2. Model 351B2 Termination